

The drawing is a detailed architectural cross-section of a building structure. It shows a wall with a roof on top and a foundation below. Key features and annotations include:

- Roof Structure:**
 - Roof slope: 5'.
 - Roofing: NR 7 ϕ 6 co 30, L = 86.
 - Roof edge details: 5' 21, 17 17, 21.
- Wall Structure:**
 - Wall thickness: 24.
 - Wall reinforcement: NR 1 4 ϕ 12.
 - Wall material: mur oporowy (load-bearing masonry).
- Foundation and Ground Level:**
 - Ground level: ± 0.00 .
 - Foundation: żelbetowe ławy fund. (reinforced concrete foundation).
 - Foundation reinforcement: NR 1 4 ϕ 12.
 - Foundation material: beton chudy (lean concrete).
 - Foundation dimensions: 20, 20, 40, 20.
- Internal Structure and Details:**
 - Internal wall thickness: 24.
 - Internal reinforcement: NR 11 ϕ 6 co 30, L = 130.
 - Internal dimensions: 150, 280, 100, 30.
 - Internal material: żelbetowe (reinforced concrete).
- Other Annotations:**
 - W-1: Window or door opening.
 - 2-2: Section line.
 - 5' 21, 39 39, 21: Roof edge details.
 - 24 51, 24 24, 24: Roof edge details.
 - NR 2 ϕ 6 co 30, L = 106: Internal reinforcement.
 - NR 1 4 ϕ 12: Internal reinforcement.
 - wg proj. konstrukcji: according to project construction.
 - 1.30: Foundation level.

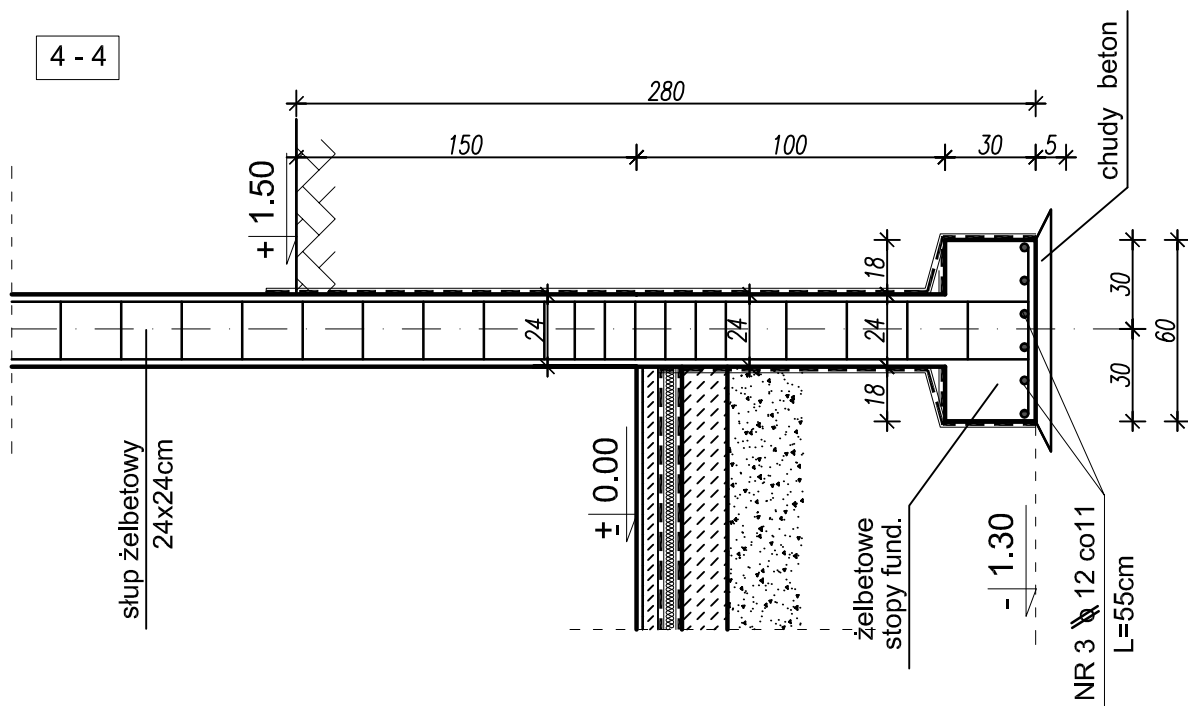

TEMAT RYSUNKU: BUDOWA DWUSTANOWISKOWEGO GARAŻU NA SAMOCHÓD OSOBOWY		INWESTOR: GMINA PIŃCZÓW, z/s 28-400 PIŃCZÓW, ul. 3-go Maja 10,		
NAZWA RYSUNKU: FUNDAMENTY – SZCZEGÓŁY		SKALA: 1:25	LOKALIZACJA: DZ.NR EW. 284, SKOWRONNO DOLNE, GMINA PIŃCZÓW,	
BRANŻA: KONSTRUKCJA		DATA: 09.2022r.	PROJEKTANT: mgr inż. Józef Skrzypczyński upr.bud.KL-21/85 SWK/0089/P00K/07	PODPIS: